

Section 1

Kitchen installation

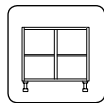

Base cabinets

Pre-build - Cabinet leg	page 16
Pre-build - Alternative cabinet leg	page 18
Pre-build - Cabinets.	page 19
Pre-build - Corner base cabinet centre upright fixing	page 20
Pre-build - Deep wall cabinet	page 21
Corner base cabinet - Asymmetrical fillet.	page 22
Corner base cabinet - Symmetrical fillet.	page 23
Corner base cabinet	page 24
931 Corner base cabinet	page 26
Blanking panel application guide	page 28
Built-under oven housing	page 29
Built-under oven housing drawer.	page 30
Built-under oven housing - Leg conversion kit	page 32
Connecting and levelling	page 33
Wall fixing	page 33

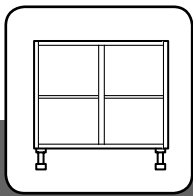

Section 1 - Kitchen installation - Base cabinets

Pre-build - Cabinet leg

Alternative leg style shown on page 18.

Leg Locations

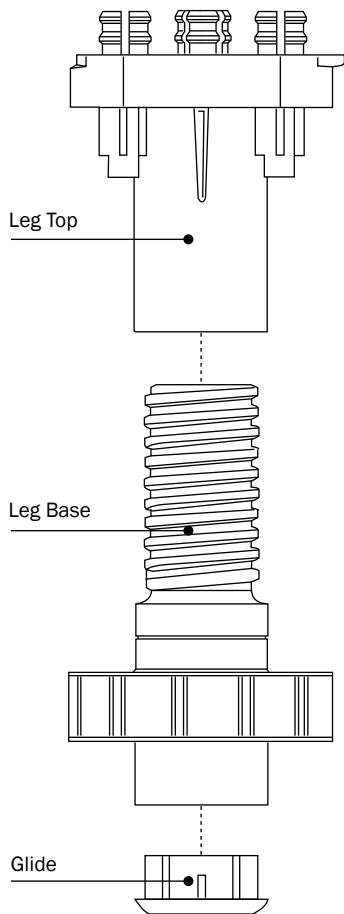
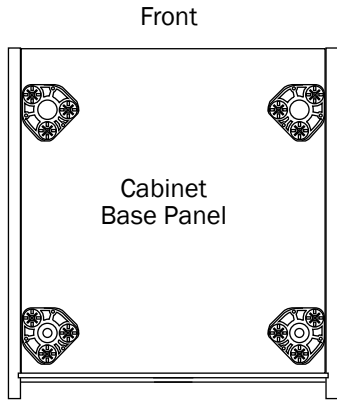

- Leg Pack:**
 x4 Leg Top
 x4 Leg Base
 x4 Glide
 x2 Cover Cap
 x2 Plinth Clips

1

Push top into cabinet base.

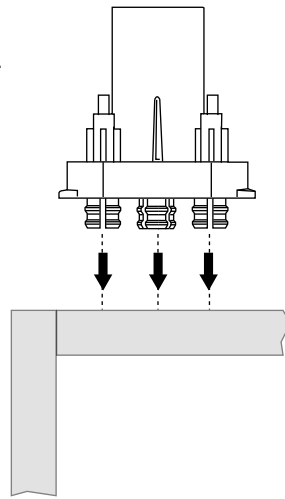

2

Knock in the 3 dowels to secure. **NOTE:** Dowels should be flush with the surface once secure.

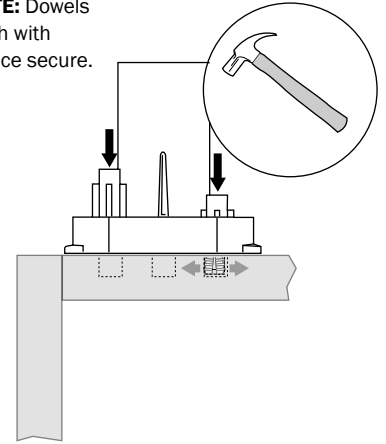

3

Screw in leg base and adjust. **NOTE:** Leg has a nominal height mark at 170mm and can be adjusted +/- 22.5mm.

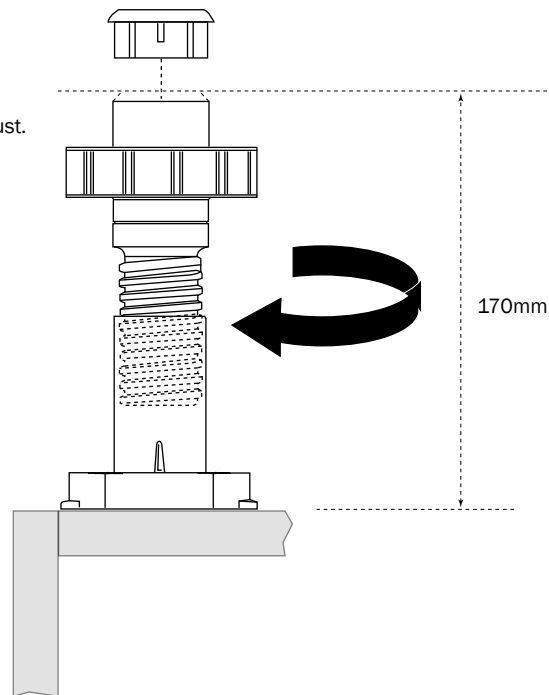

4

Adjustment of the cabinet back legs can be made from inside the cabinet.

Fit cover caps to the cabinet holes once adjustment is complete.

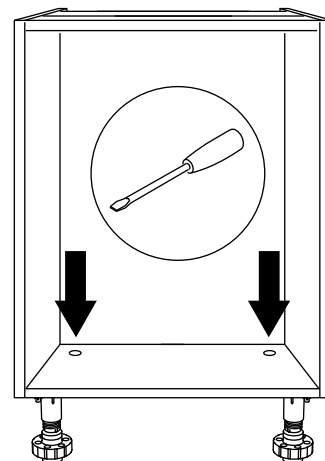
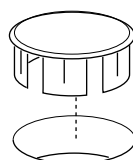

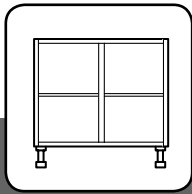

Section 1 - Kitchen installation - Base cabinets

Pre-build - Cabinet leg

Plinth Clip

Lay the plinth face down with the bottom edge against the run of cabinet legs. Mark the positions of the leg onto the back of the plinth using a pencil.

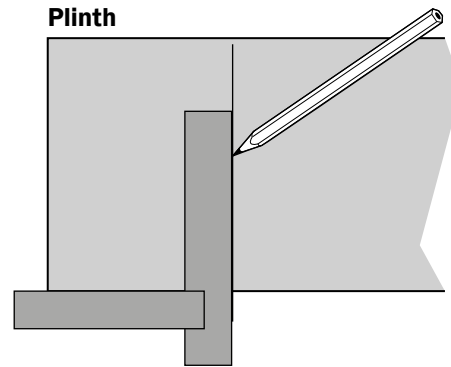

Position the plinth clip bracket to the plinth, aligning the notch with the pencil mark and secure using the screws provided.

NOTE: Use the plinth clip to space the bracket from the top edge. When fitting a return plinth turn the bracket 180 degrees so the clip, when fitted, is towards the bottom of the panel and clips do not clash when fitting to the same leg. Fit the clip into the bracket, slotting into place.

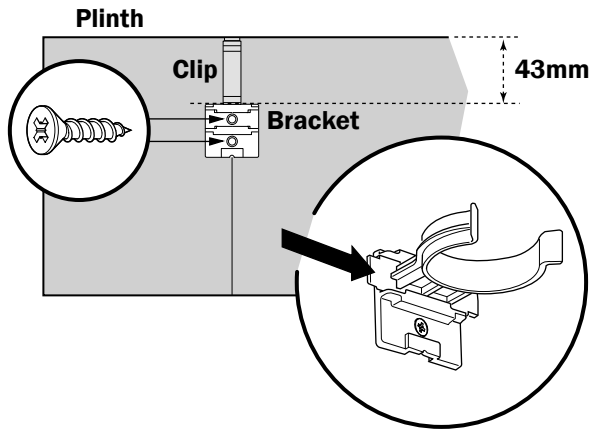

Turn plinth bracket 180 degrees so clip can be fitted to the bottom of the bracket

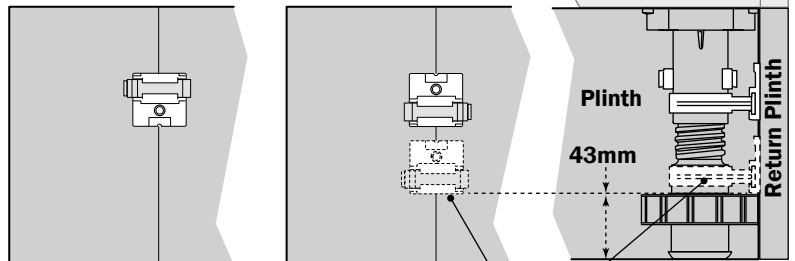

NOTE: Additional plinth clip/bracket can be positioned at the bottom of the leg, (43mm from bottom edge), if required in return application

Fitting legs to wall cabinets

When using the leg in a shallow base unit application (ie. fitting to a wall cabinet), the plastic location dowels will require removing.

1. Remove the plastic location dowels.

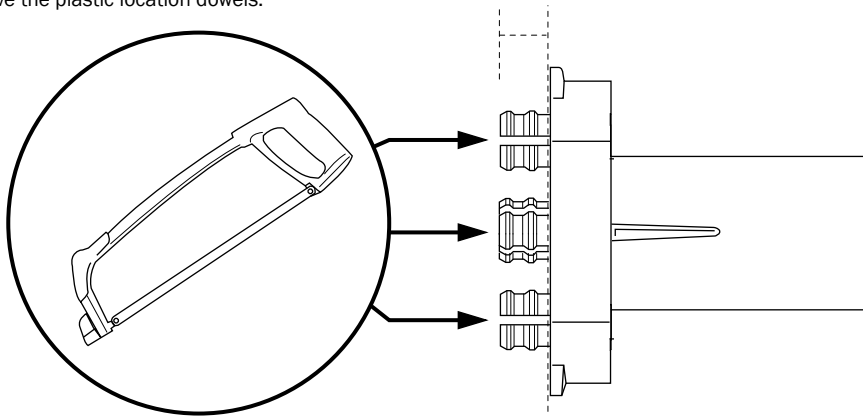

2. Position the legs in line with the other leg positions in your cabinet run.

Pilot drill and secure through the three fixing holes in the leg top with screws.

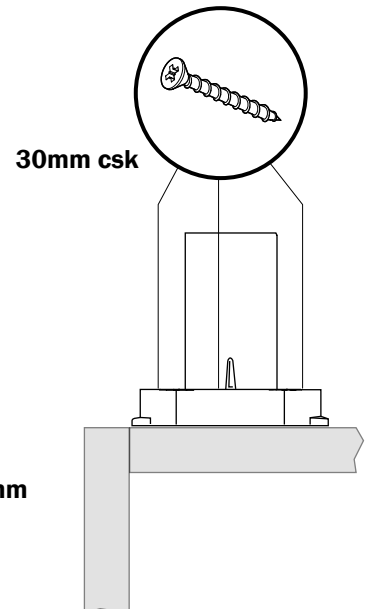
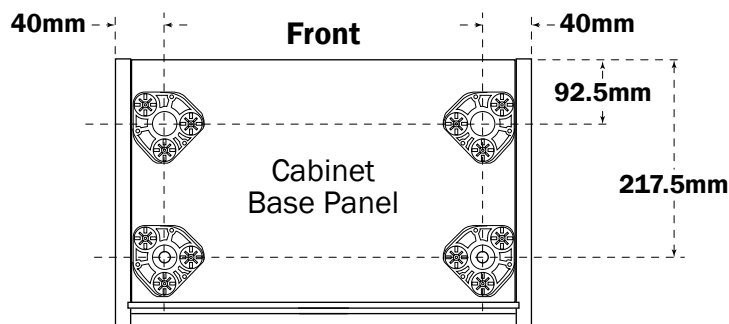

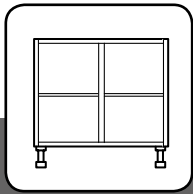

Section 1 - Kitchen installation - Base cabinets

Pre-build - Alternative cabinet leg

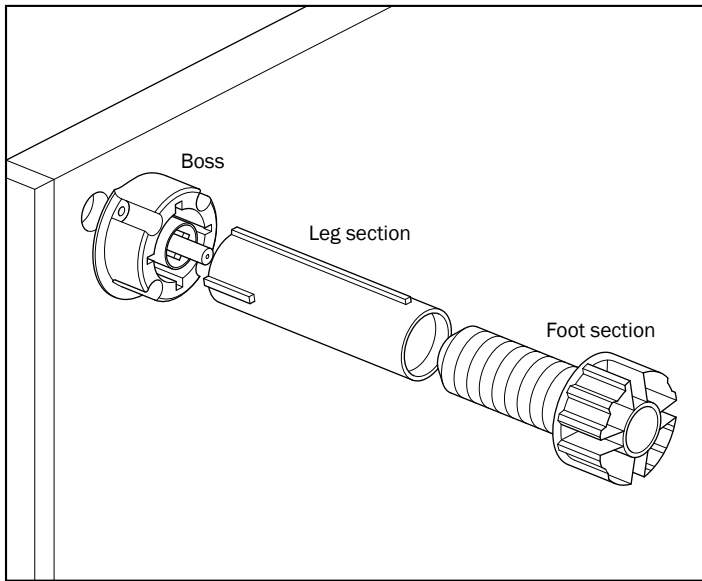

Cabinet leg

Fit the leg boss to the cabinet aligning the plastic lug with the hole.

NOTE: Make sure the flange of the leg boss overlaps the cabinet side panel.

Firmly tap the centre plastic pin in the leg boss to expand the plastic lug and secure the leg boss.

NOTE: Screws can be used, however are not required and therefore not supplied.

Fit the leg section, pushing into the leg boss, then screw on the foot section.

NOTE: Legs can be cut down using a hacksaw, if required.

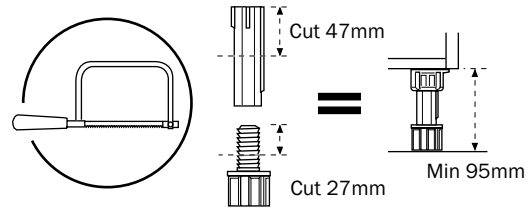

1
Push into base

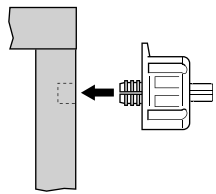

2
Knock in dowel.
Ensure the lip of the leg overlaps
the base and side panel joint.

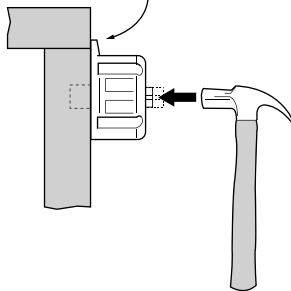

3
Push in leg section

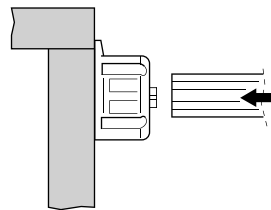

4
Screw in foot section

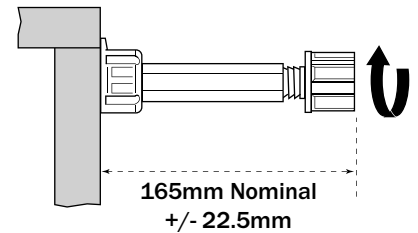

Tower pull-out 5th leg fixing

For extra stability and support fit a 5th leg to the front central position of the cabinet base panel.

Use the information below to secure the leg.

NOTE: We recommend the additional leg is secured to the cabinet before the pull-out accessory is fitted.

1 Remove the plastic location dowel.

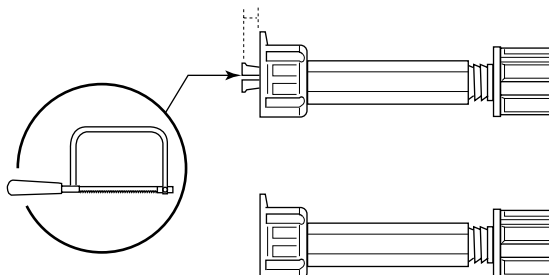

2 Position the leg centrally and secure in line with the other leg position.

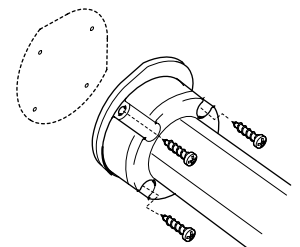
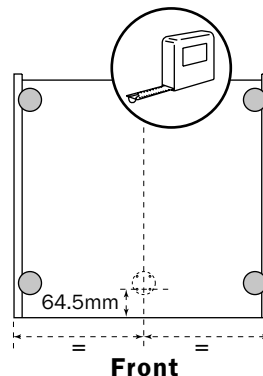

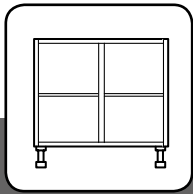

Section 1 - Kitchen installation - Base cabinets

Pre-build - Cabinets

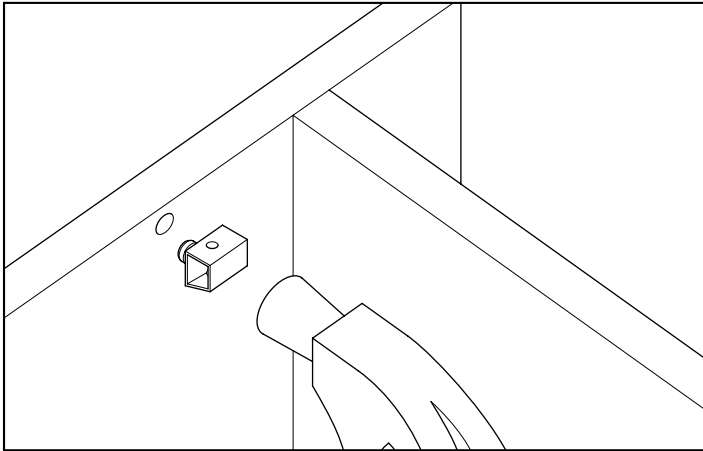

Worktop fixing brackets

Support the end panel before knocking in the fixing bracket.

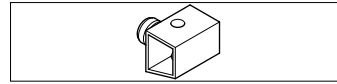

Worktop fixing bracket

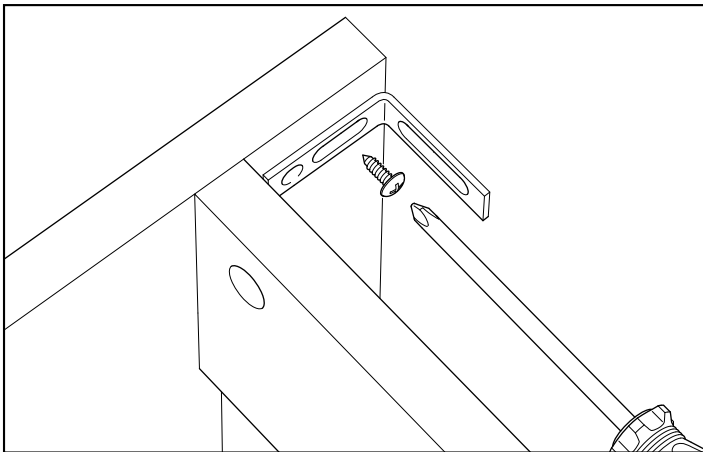

Base cabinet, fixing brackets

Brackets should be fitted to each end of the cabinet and in alignment with the access holes drilled in each end of the back rail.

Once the cabinet is secured to the wall, lock the bracket in place using a screw through the round hole.

NOTE: Cover caps are provided to blank the access holes.

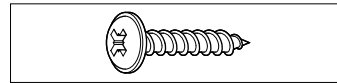

16mm Flange head screw

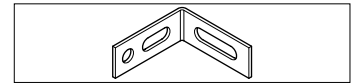

Fixing bracket

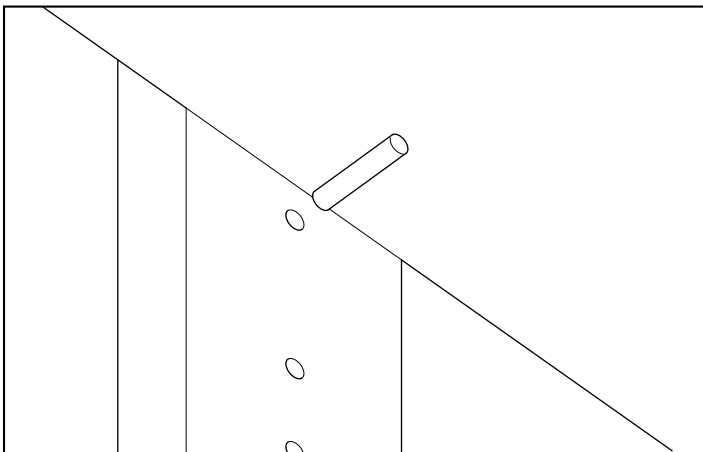

Mid shelf support, 800/900/1000 cabinets

Shelf pegs have been supplied for centre fixing, as shown. This is to prevent shelf deflection.

If an additional peg is required at the back of the cabinet a 5mm hole will need to be drilled before locating the shelf peg. This should be done for Level H compliance.

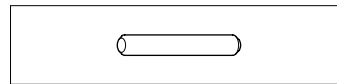

Metal shelf barrel peg

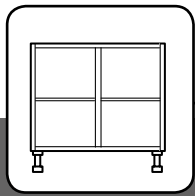

Section 1 - Kitchen installation - Base cabinets

Pre-build - Corner base cabinet centre upright fixing

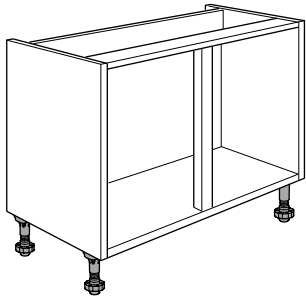

NOTES:

Remove the transit rail from the cabinet.
The centre post has not been pre-fitted into the cabinet to allow for different corner door size applications.

Application example

1000mm Cabinet

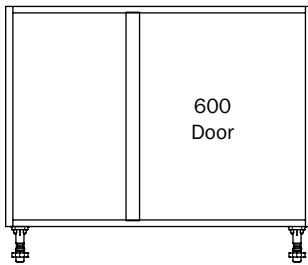

600 Door position

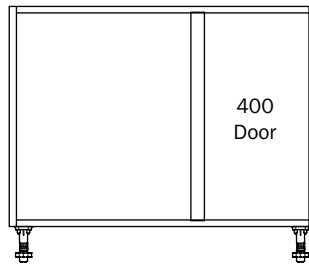

400 Door position

800mm Cabinet

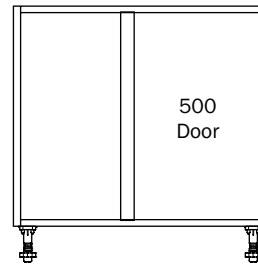

500 Door position

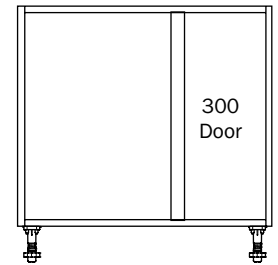

300 Door position

Assembly

1

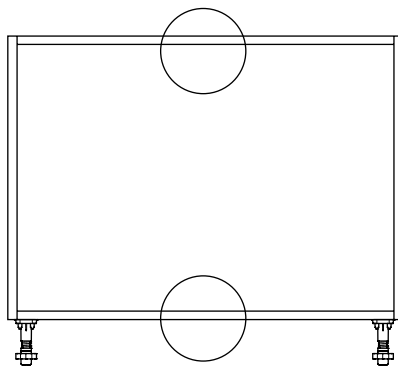

Fixing positions for the centre post fixing have been pre-spiked into the cabinet rail and part pre-drilled in the underside of the base panel. Select the holes required and drill through using a 5mm bit.

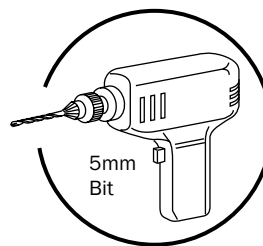

5mm Bit

2

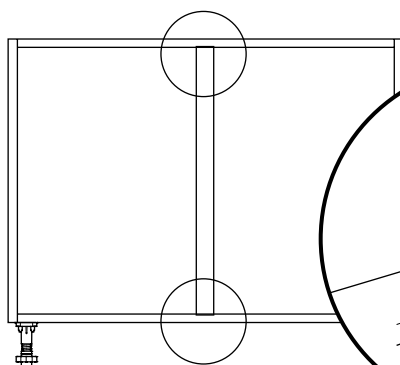

Screws x4 (45mm)

Fit the new centre post to the cabinet and secure in place using the screws supplied.

NOTE: Make sure the upright is flush with the front edge of the cabinet.

Centre post x1

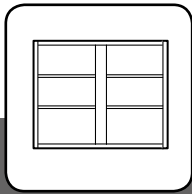

Section 1 - Kitchen installation - Wall cabinets

Pre-build - Deep wall cabinet

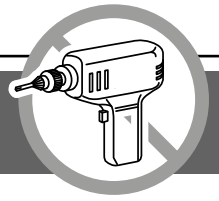

Concealed wall cabinet hanging brackets are supplied in the fittings pack.

NOTE: Power tools must not be used when fitting the brackets.

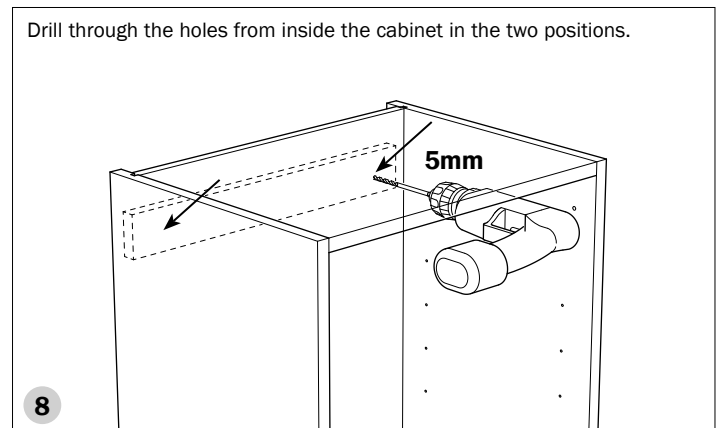
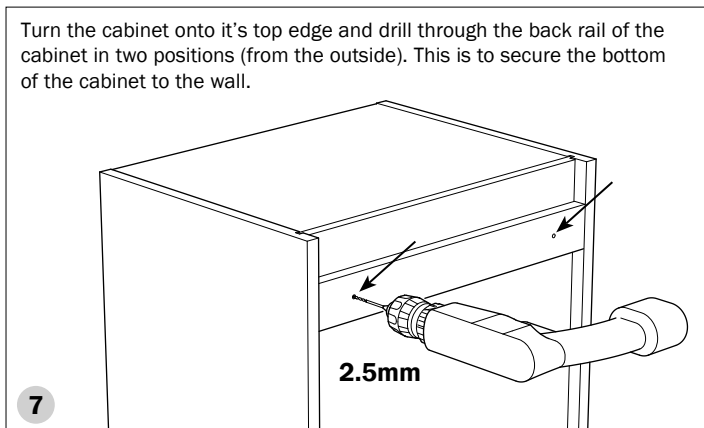
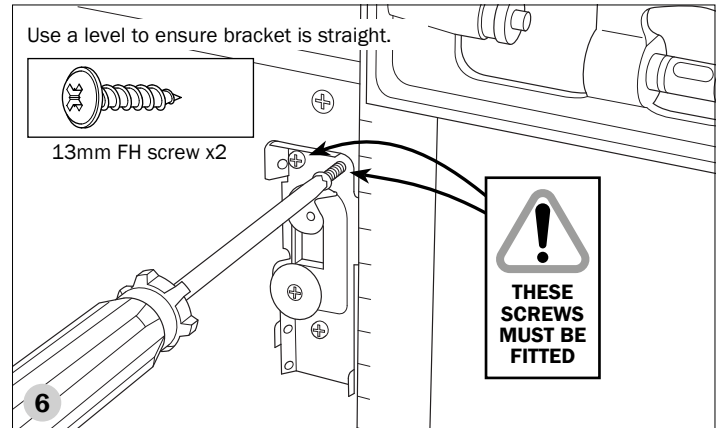
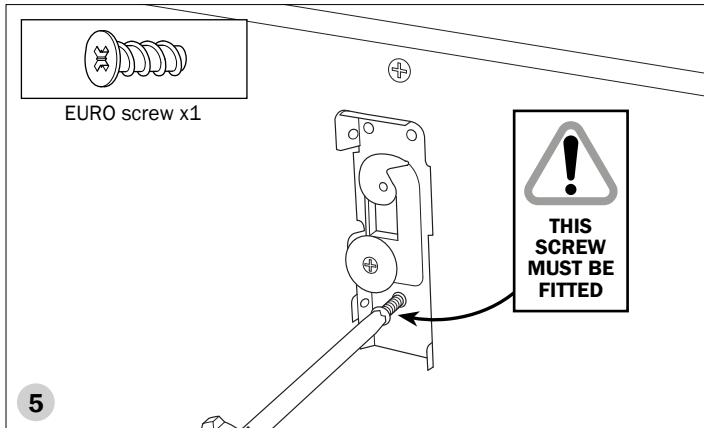
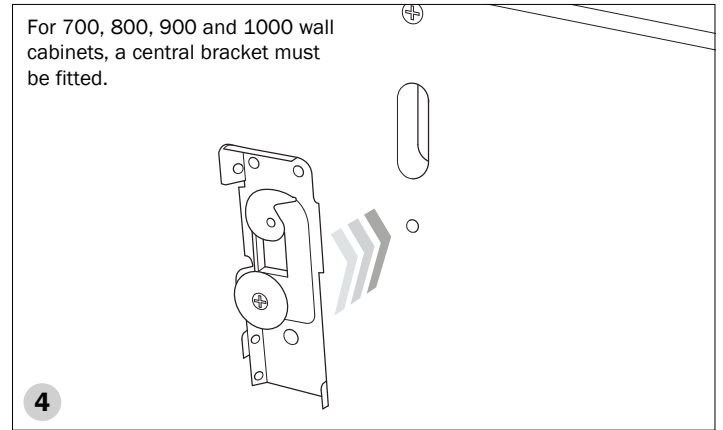
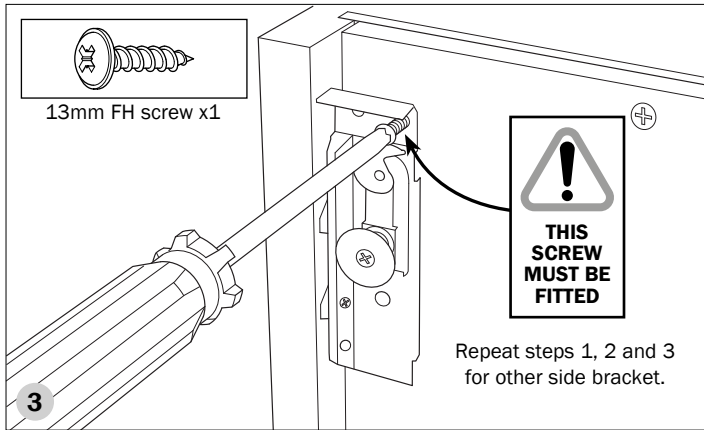
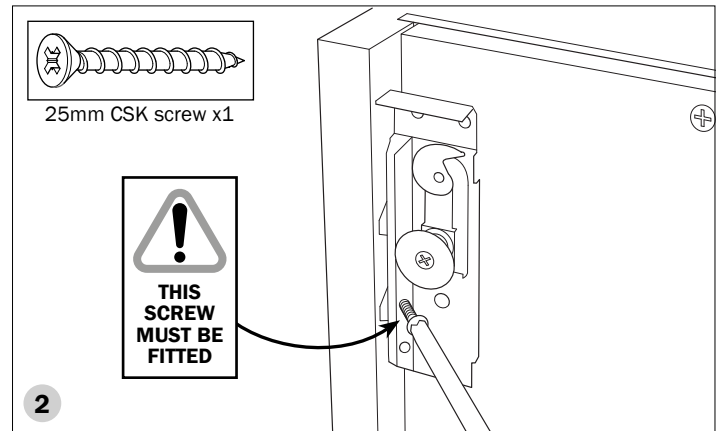
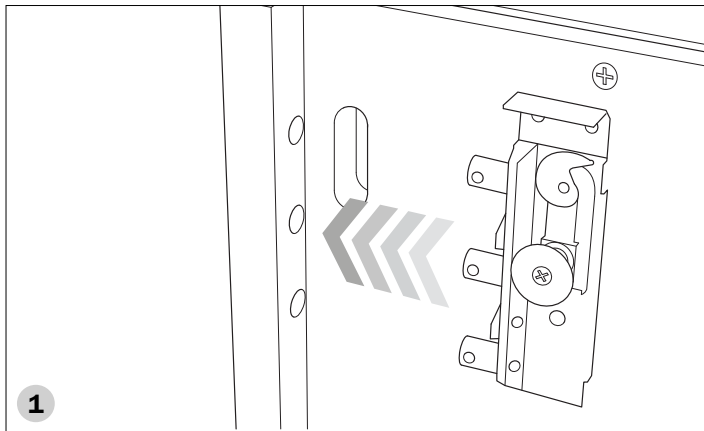

For securing the deep wall cabinet to the wall, see **page 83**.

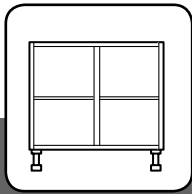

Section 1 - Kitchen installation - Base cabinets

Corner base cabinet - Asymmetrical fillet

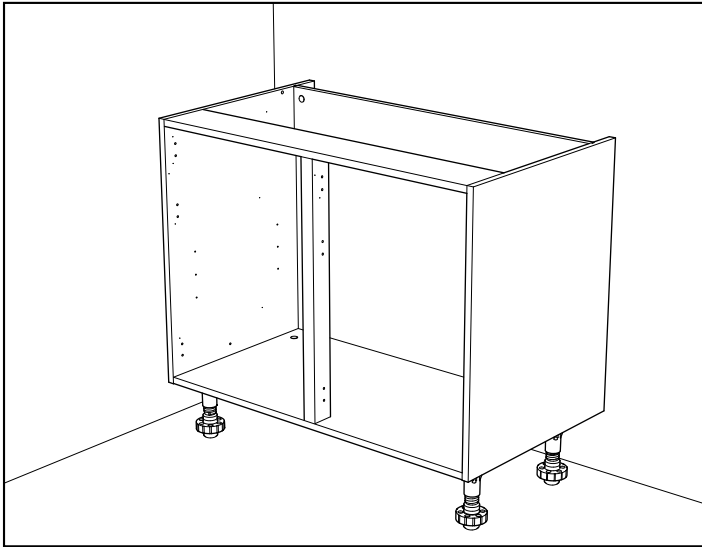

800/900/1000 Hi-line and drawer-line corner cabinets

Fit two fixing blocks to each side of the fillet top and bottom locating into the groove on one side and flush with the edge on the other.

Position the fillet to the cabinet centre upright and secure.

NOTE: For corner cabinets using different door sizes, remove the transit rail at the front of the cabinet and replace with the new centre post supplied with the order.

NOTE: If a run of base cabinets is to include a 'fitted' or 'freestanding' appliance, adjust the height of the cabinets to suit the height of the appliance.

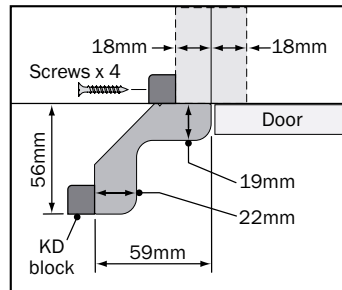
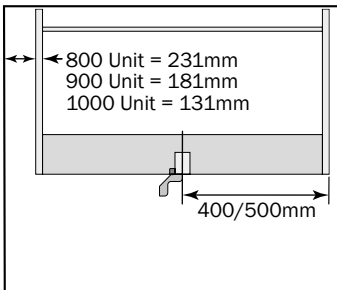
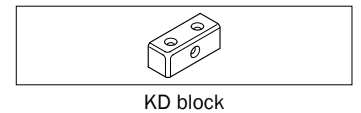
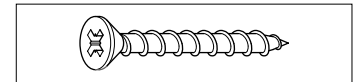
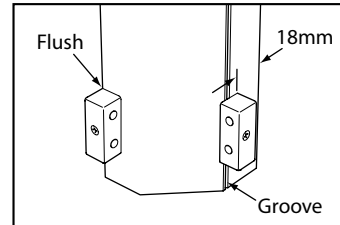
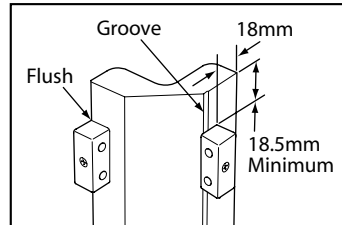
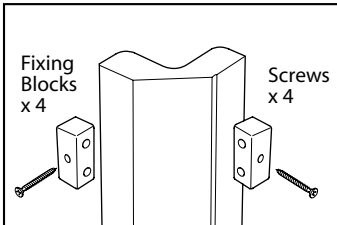

NOTE: For integrated handle kitchen corner base cabinet fillet fixing, please refer to [page 112](#).

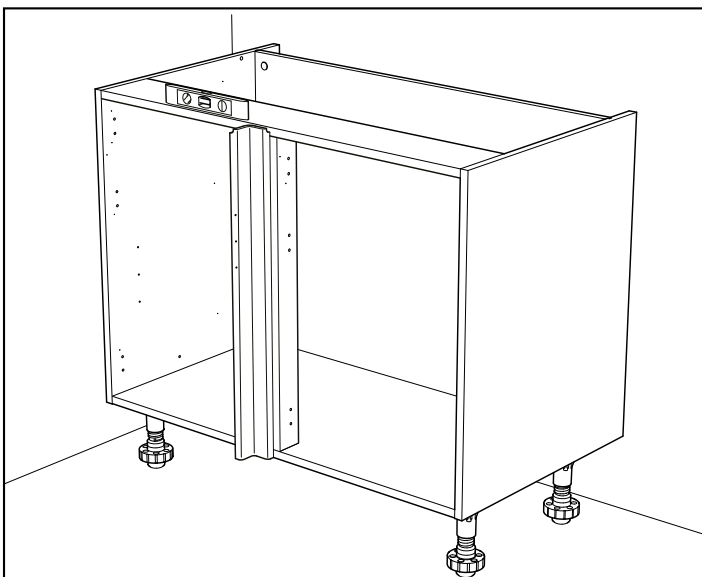

Mark the wall 231mm from corner for 800 cabinets, 181mm from corner for 900 cabinets and 131mm from corner for 1000 cabinets. Position cabinet against wall up to the mark.

Level side to side and front to back by turning the adjustable ends of the feet as necessary.

DO NOT FIX TO WALL AT THIS STAGE

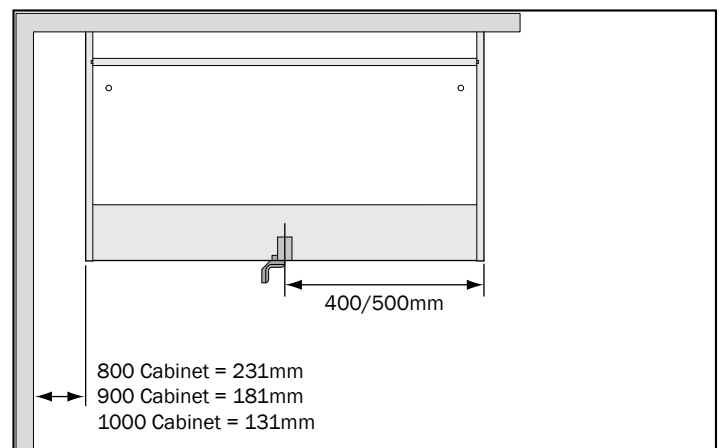

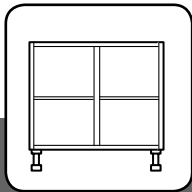

Section 1 - Kitchen installation - Base cabinets

Corner base cabinet - Symmetrical fillet

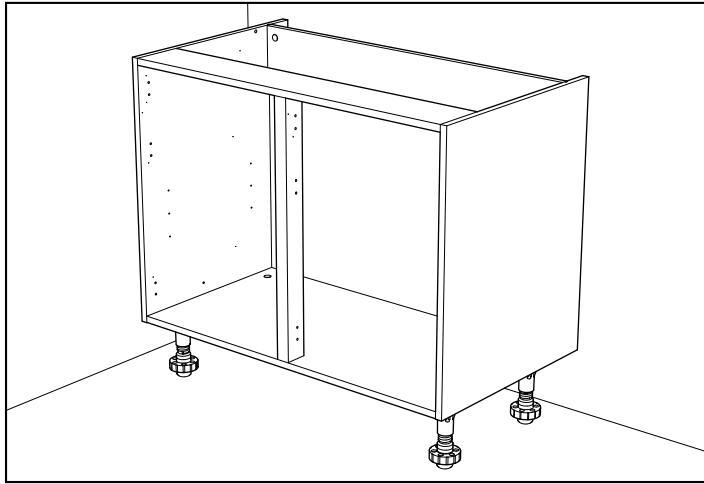

800/900/1000 Corner cabinets

Fit two fixing blocks to each side of the fillet top and bottom locating into the groove on one side and flush with the edge on the other.

Position the fillet to the cabinet centre upright and secure.

NOTE: For corner cabinets using different door sizes, remove the transit rail at the front of the cabinet and replace with the new centre post supplied with the order.

NOTE: If a run of base cabinets is to include a 'fitted' or 'freestanding' appliance, adjust the height of the cabinets to suit the height of the appliance.

- 1** Fit two fixing blocks each side of the fillet top and bottom.
NOTE: In a corner application where two single cabinets are being used, the fixing blocks on both sides of the fillet should be positioned aligning with the edge.

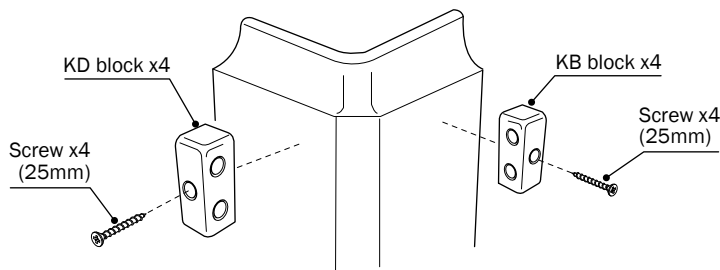

- 2** Position the fillet to the cabinet centre upright and secure. Fit the adjoining cabinet and secure fillet to the side fixing through the KD blocks.

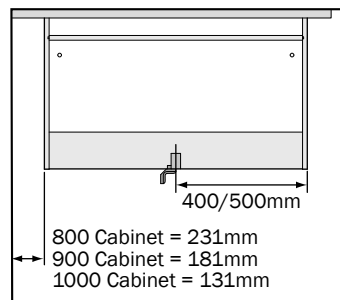
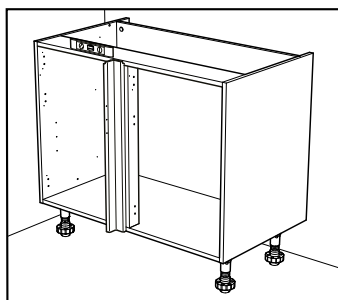
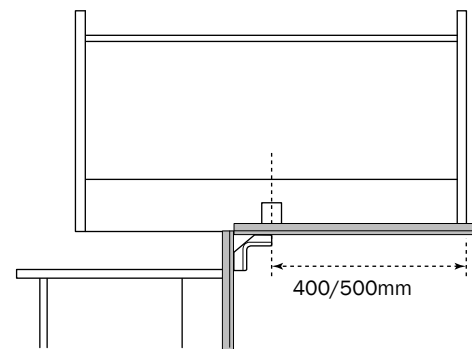
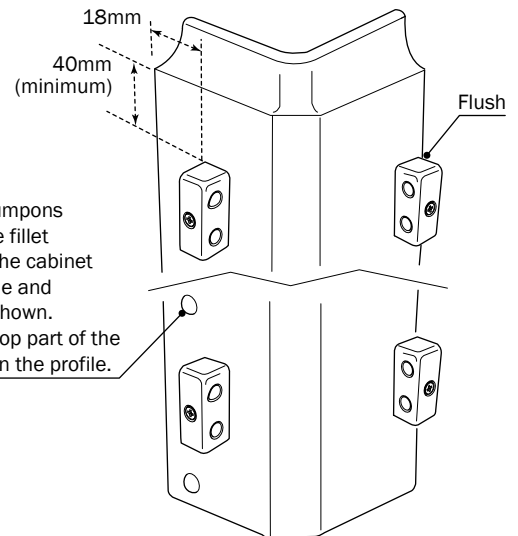
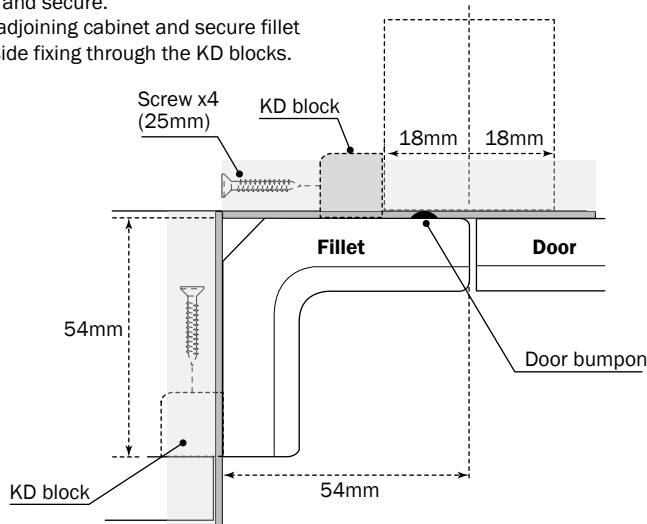

Level side to side and front to back by turning the adjustable ends of the feet as necessary.

DO NOT FIX TO WALL AT THIS STAGE

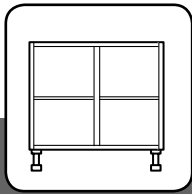

Section 1 - Kitchen installation - Base cabinets

Corner base cabinet

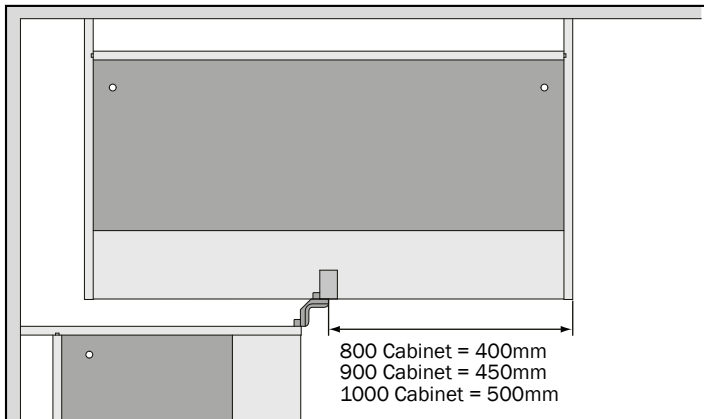

800/900/1000 Hi-line, drawer-line and larder corner cabinets

Position the cabinet you require to turn the corner and run at right angles to the first cabinet. Place the cabinet against the wall and line up with the corner fillet as shown in the diagram. Use the straight edge and a spirit level when adjusting the feet to continue the level. After levelling and positioning a number of cabinets in this direction, connect together, but not more than a run of 2.5M. Do not connect to the corner cabinet. Fix the cabinets to the wall, see **page 33**.

Fix with 2 countersunk screws through the 2 KD blocks on the back of the fillet into the end panel of adjacent cabinet.

NOTE: The cabinet is correctly positioned when an 18mm distance is achieved as shown.

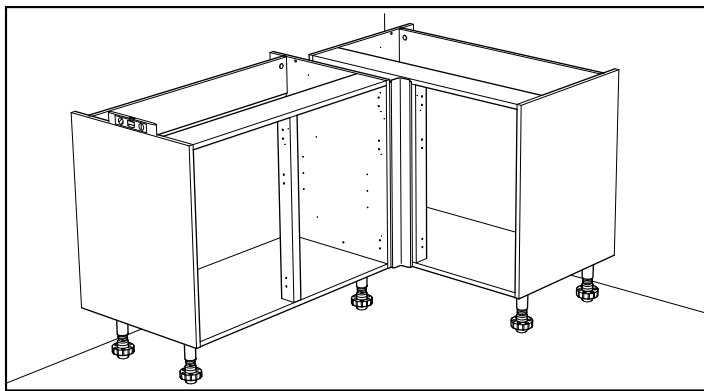

Asymmetrical

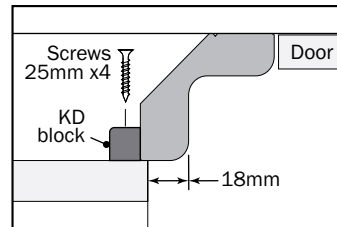

Symmetrical

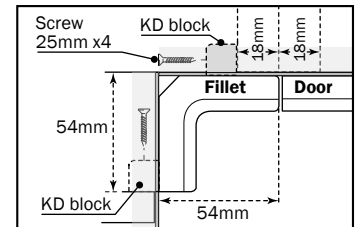

Corner larder

Fit the top section of the larder to the base section. Secure up through the front rail of the base cabinet with screws, and at the back with the worktop fixing brackets as shown.

Once the corner larder is in place, secure to the wall at the top using the larder brackets.

NOTE: If you are fitting cornice to the kitchen, do not secure the brackets to the exposed side of the unit. The bracket should be fixed to the cornice once fitted. The fillet will require cutting down for full height corner larder tower units.

IMPORTANT: To reduce the risk of damage to cut edges due to moisture ingress (where they are exposed to moisture) all raw edges must be sealed using a waterproof varnish or PVA.

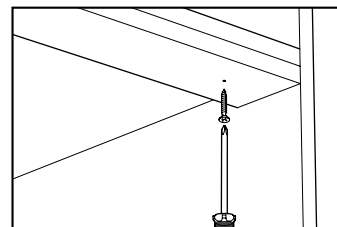

40mm CSK screw

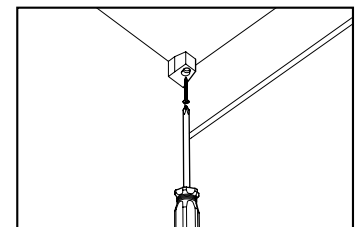

30mm CSK screw

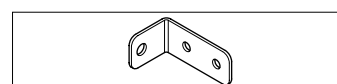
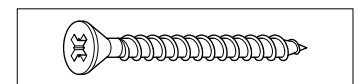
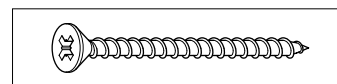

Larder bracket

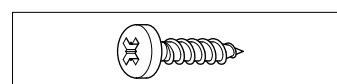

12mm Pan head screw

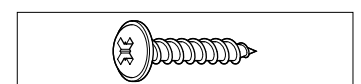

16mm Flange head screw

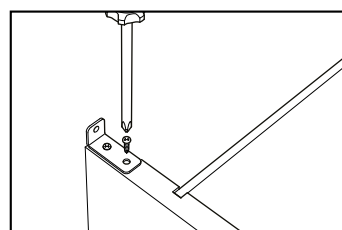
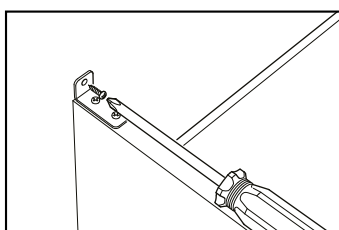

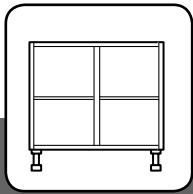

Corner base cabinet

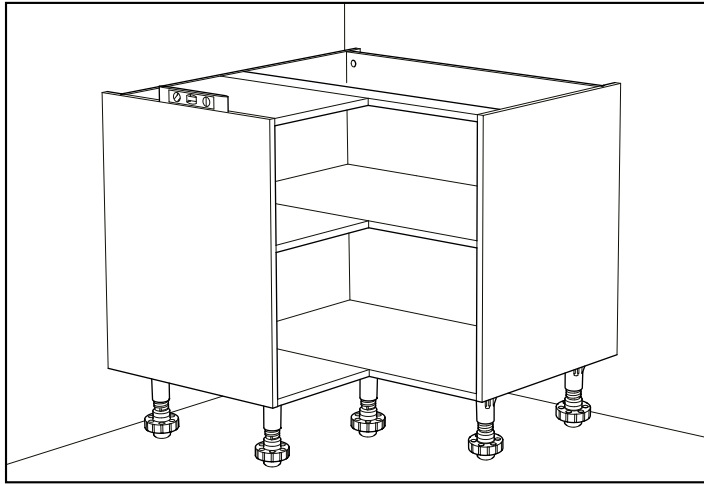

931 Corner base cabinet

Place corner base cabinet tight into the corner. Level carefully ensuring that all 7 feet are adjusted correctly. Once it has been positioned it can be left until the cabinets on both sides are fixed to the walls. For assembly instructions, see [page 26-27](#).

NOTE: The service void on the 931 corner cabinet is now between 66-72mm.

NOTE: See [page 28](#) for blanking panel application.

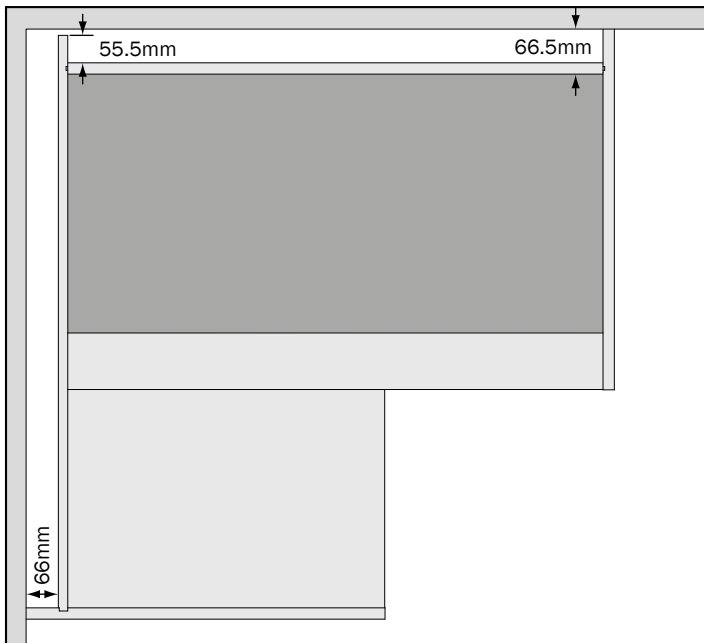

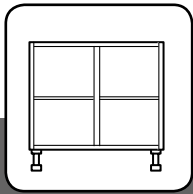

Section 1 - Kitchen installation - Base cabinets

931 Corner base cabinet

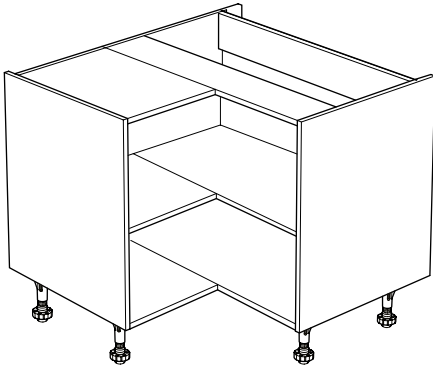
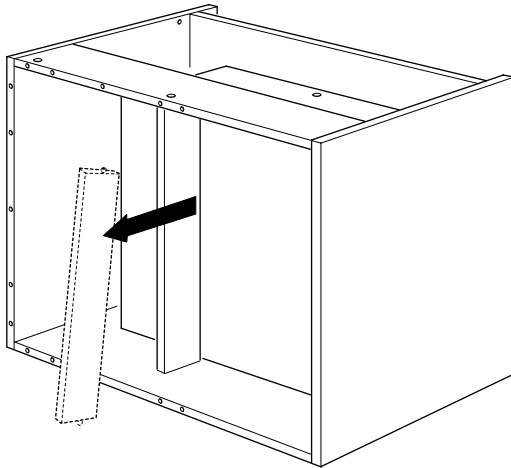

Illustration shows additional shelf pack fitted.

Assembly

- 1** Remove transit rail from the cabinet.



- 2** Remove small cabinet.

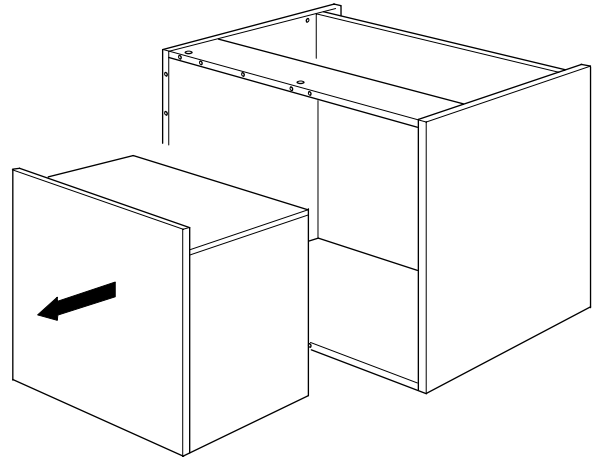

- 3** Lay the large cabinet on its back edge and fit cams.

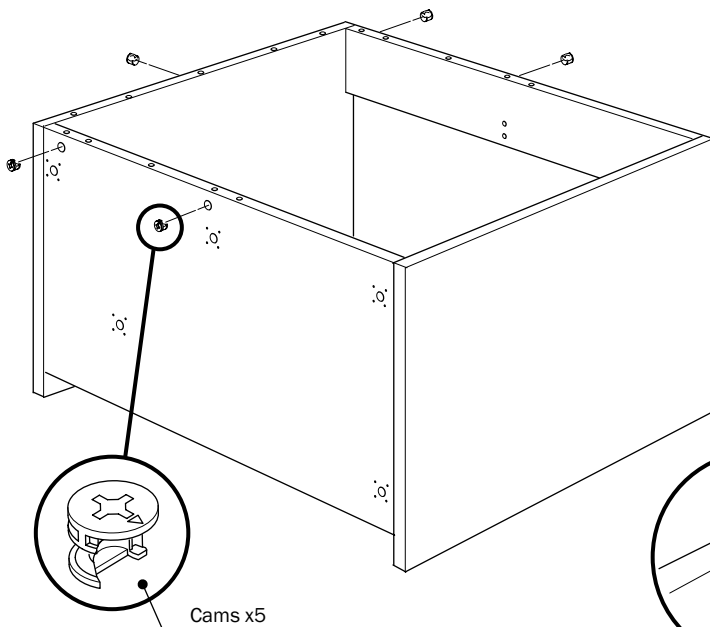

- 4** Fit dowels, cams and cam studs to the small cabinet, turning cams to lock studs in position.
NOTE: Glue dowels into position.

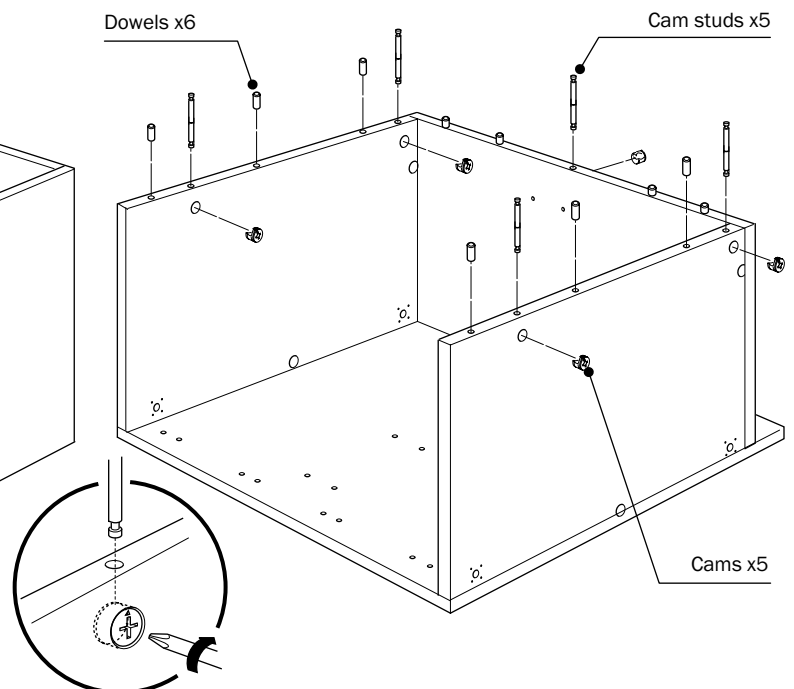

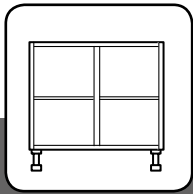

Section 1 - Kitchen installation - Base cabinets

931 Corner base cabinet

- 5** Fit the small cabinet to the large cabinet aligning the dowels with glued dowel holes and cam studs with cams.
NOTE: Make sure all cam studs are secure.

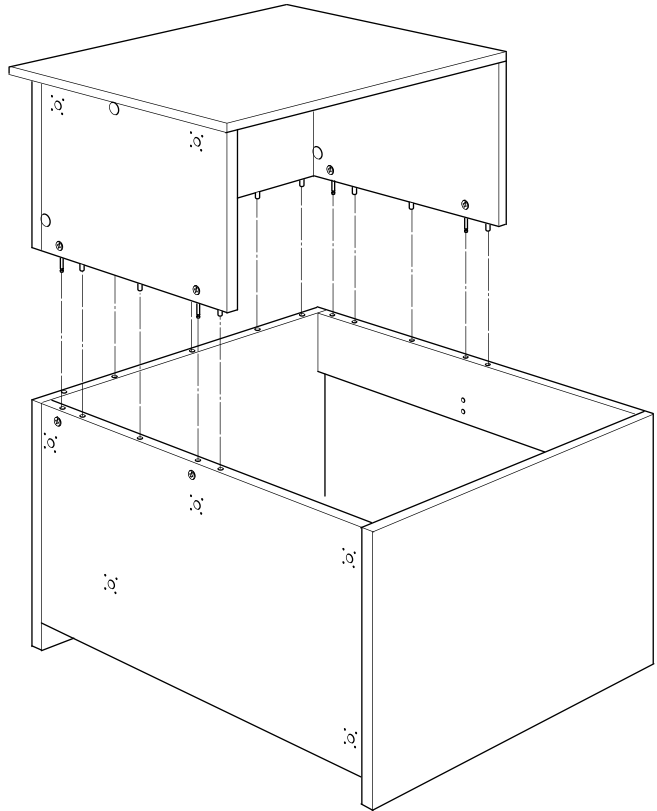
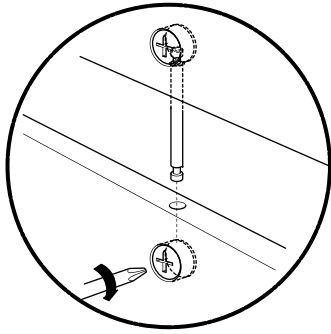

- 6** Fit the feet (x7) to the underside of both cabinet sections, see **pages 32-33** for additional information.

Push top into cabinet base.

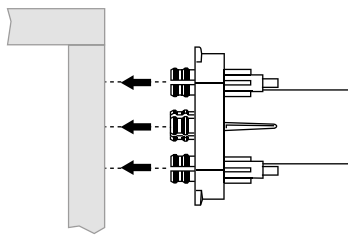

Knock in the 3 dowels to secure.
NOTE: Dowels should be flush with the surface once secure.

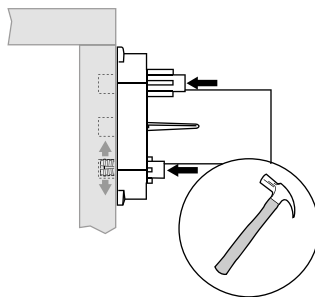

Screw in leg base and adjust.
NOTE: Leg has a nominal height mark at 170mm and can be adjusted +/- 22.5mm.

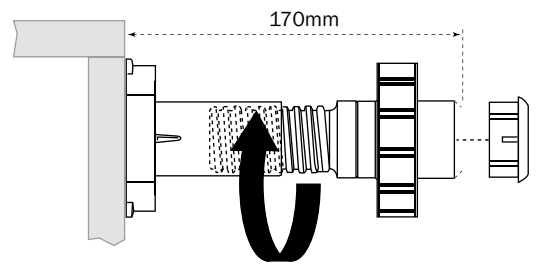

Mid shelves

Fit the shelf sections together using the cams, studs and dowels.
NOTE: Shelf components and fittings are supplied as an additional pack.

Fit the shelf pegs into the cabinet then position shelf.

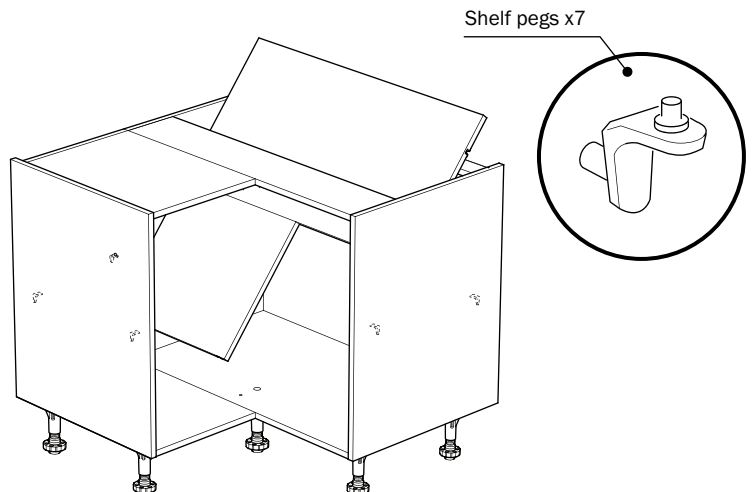
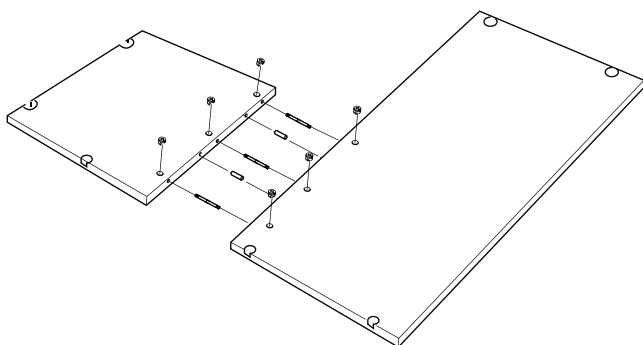

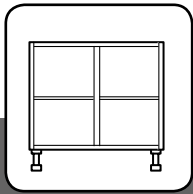

Section 1 - Kitchen installation - Base cabinets

Blanking panel application guide

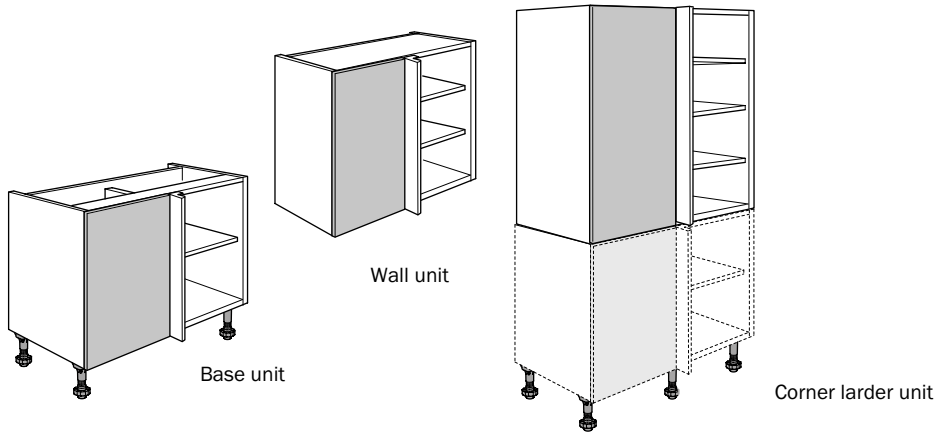

Assembly

- 1 Fit the blanking panel to the base and wall unit using suitable fixings.

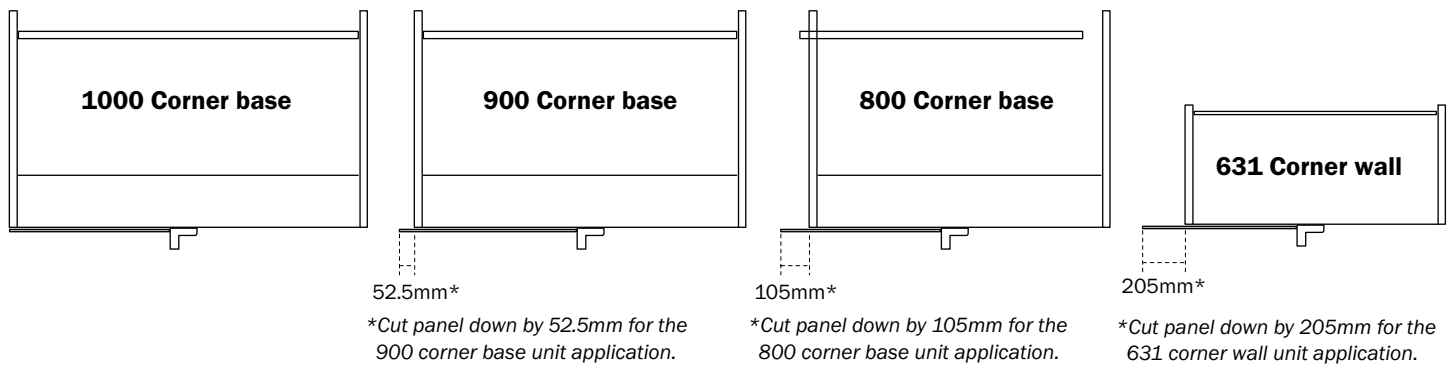
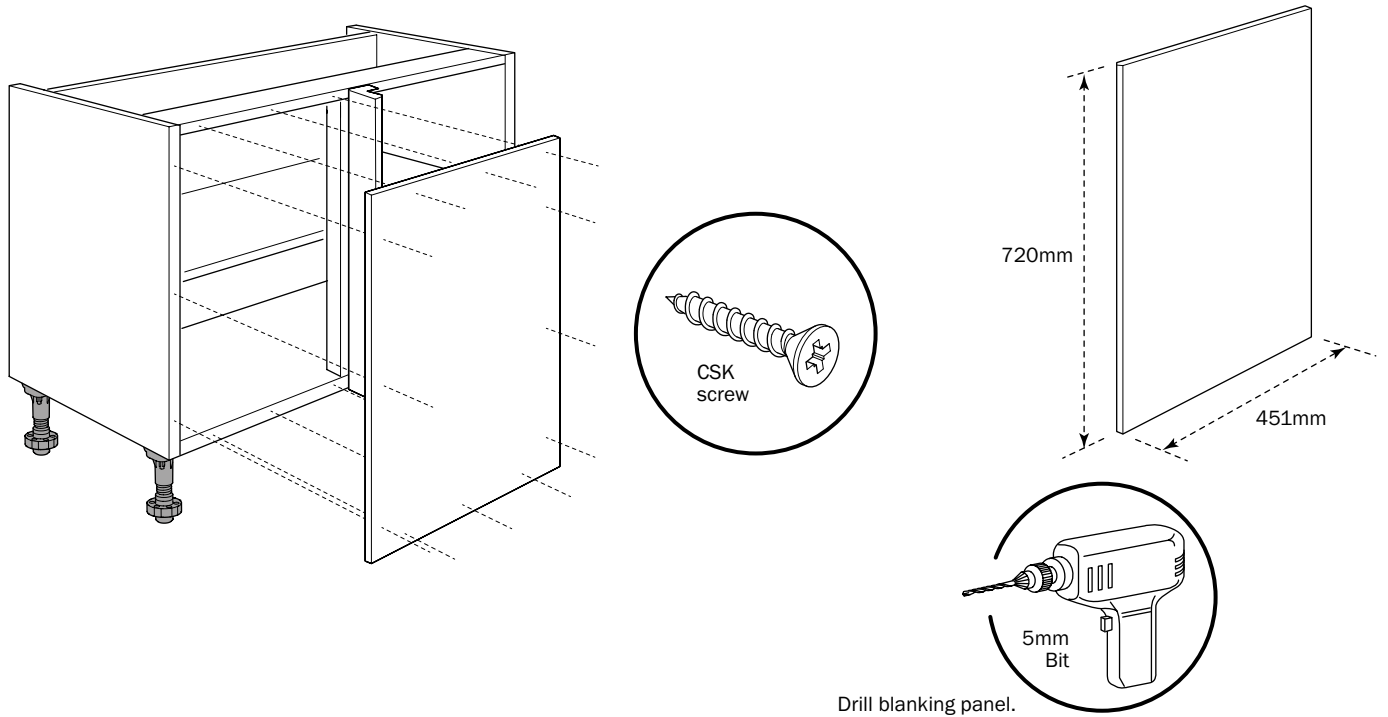

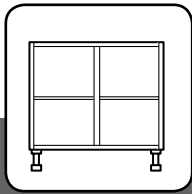

Section 1 - Kitchen installation - Base cabinets

Built-under oven housing

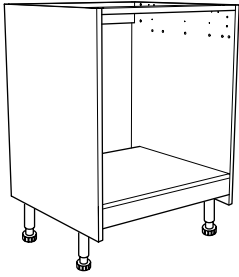

IMPORTANT NOTES:

This leaflet shows how to adapt the Premium BUOH cabinet to suit your appliance application.

Fit the appliance into the cabinet following the information in the appliance instruction booklet.

All applications

Fitting the cabinet legs and removal of the front rail are required in all applications.

NOTE: The front rail should not be removed until all other cabinet modifications have been made.

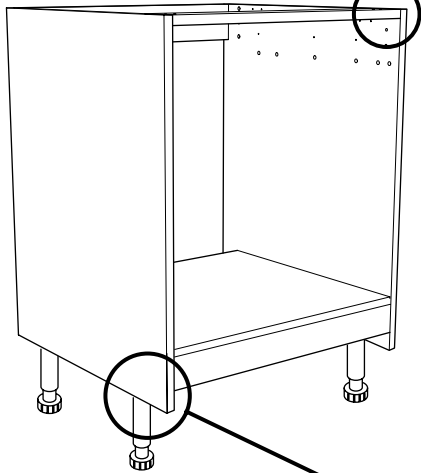
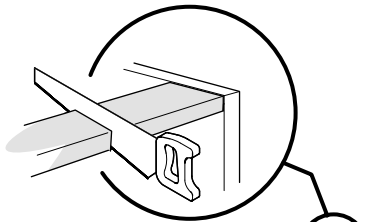

Screw x8
4 x 30mm CSK

Leg x4

Screw x16
3.5 x 13mm CSK

Standard configuration

Fit the fascia to the front rail using the screws to secure.

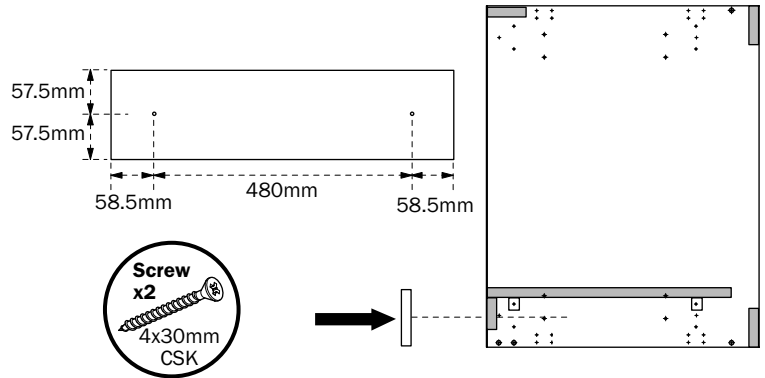

Standard configuration with drawer

Remove the rail from the front of the shelf.

NOTE: Follow the leaflet supplied with the drawer pack for drawer installation.

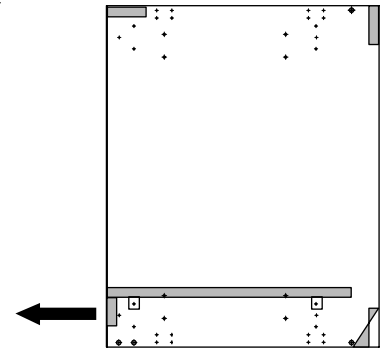
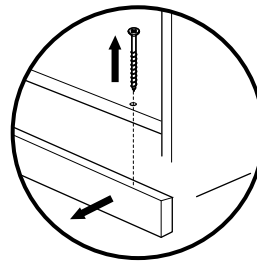

Alternative configuration

Re-position shelf to its lower position on the side panel using the cam and stud to secure. Fit two fascias (top and bottom) to the cabinet.

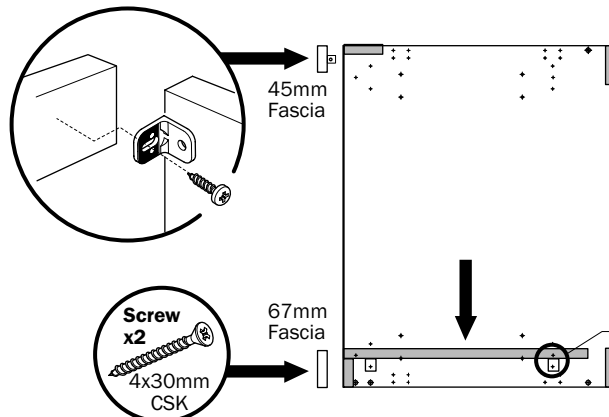

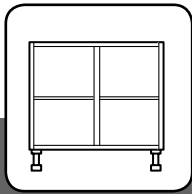

Section 1 - Kitchen installation - Base cabinets

Built-under oven housing drawer

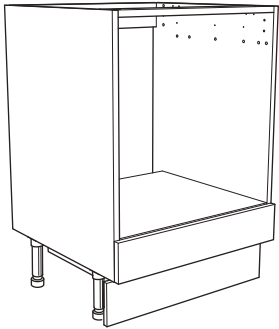

Please ensure there is sufficient clearance for the drawer to open once flooring has been installed

Assembly

1 Fit legs.

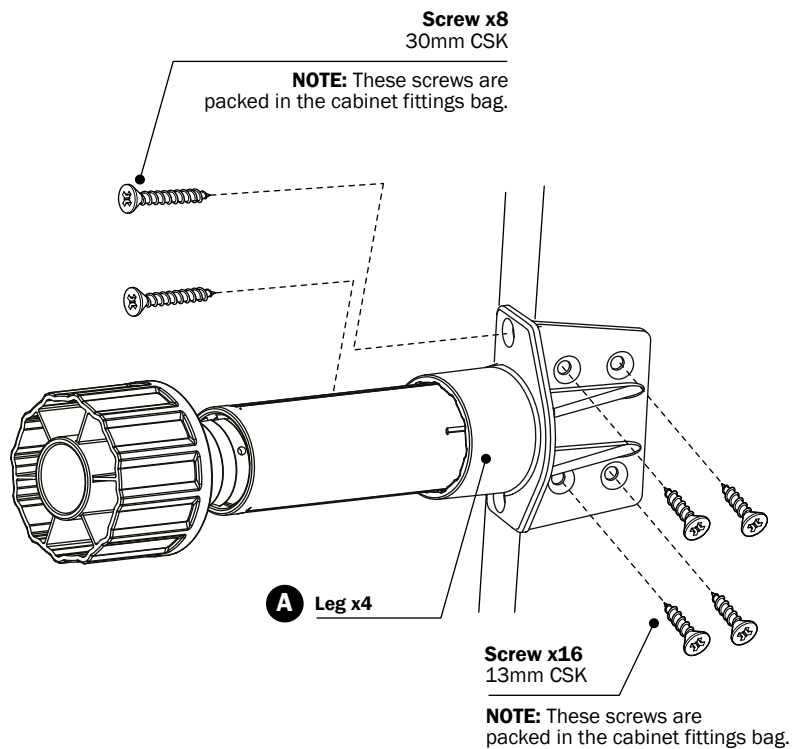
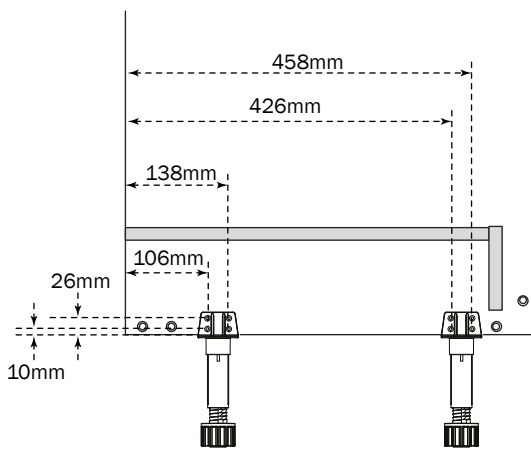

2 Fit runner.

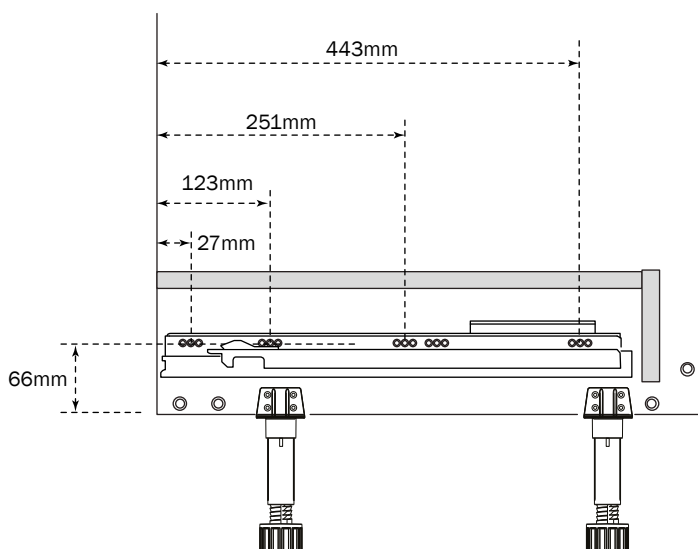

Screw x8
20mm CSK

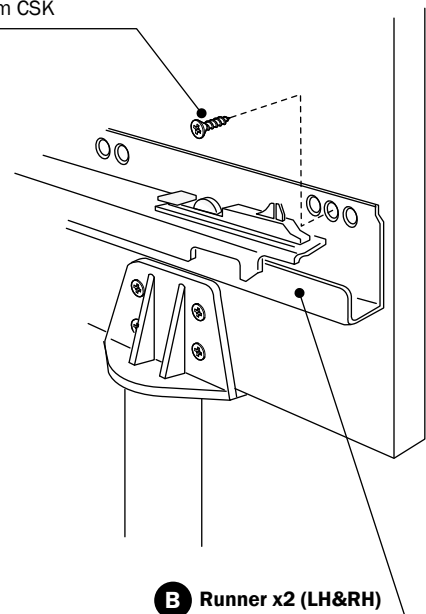

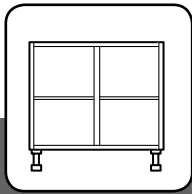

Section 1 - Kitchen installation - Base cabinets

Built-under oven housing drawer

Assembly

- 3** Cut plinth section to length. Fit brackets to lower fascia section.

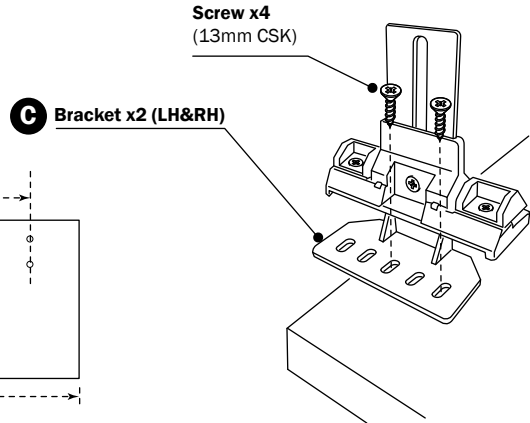
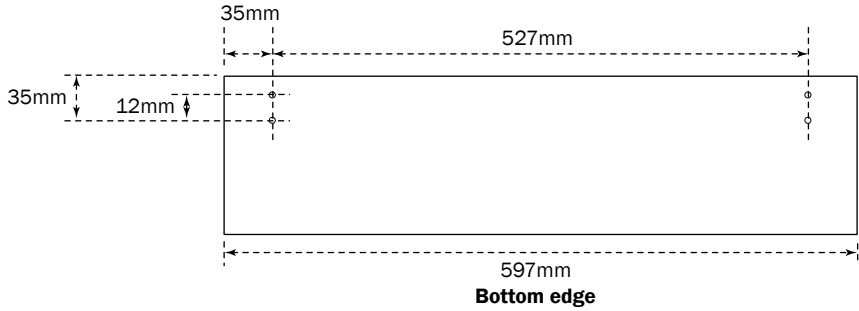

- 4** Fit clips to upper fascia.

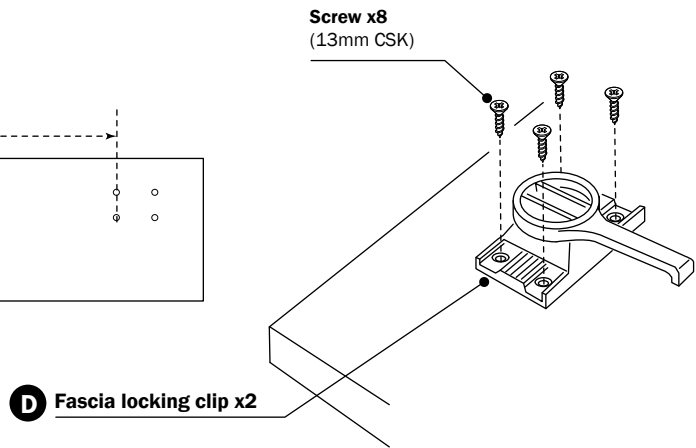
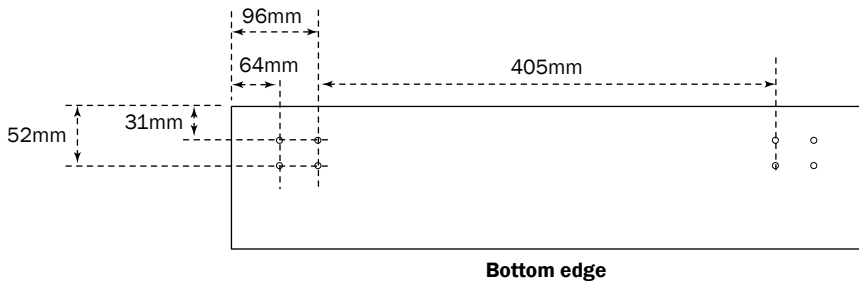

- 5** Fit runner sections to drawer sides.

Fit lower frontal to drawer slotting into place.

Tighten screws to secure.

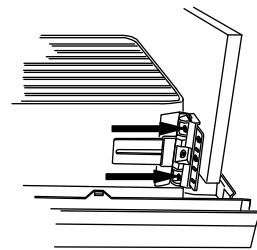
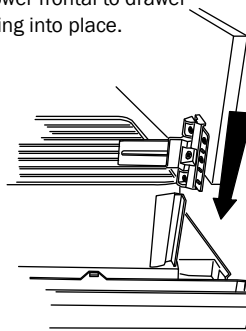
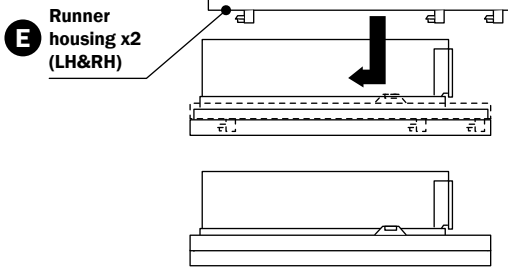

- 6** Fit fascia to drawer and lock into place.

Fit drawer onto runners
NOTE: Fully extend runners then locate drawer.

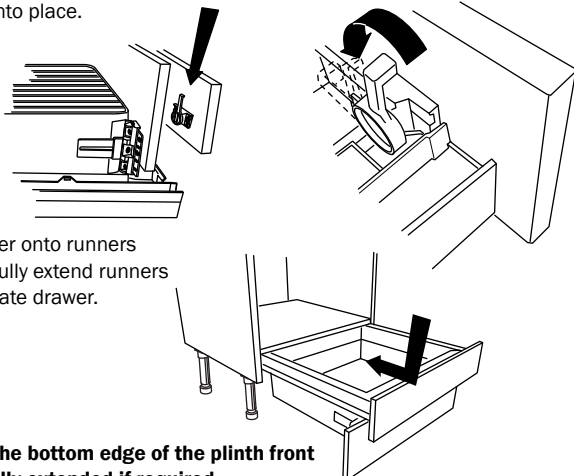

Scribe the bottom edge of the plinth front when fully extended if required.

Adjustment

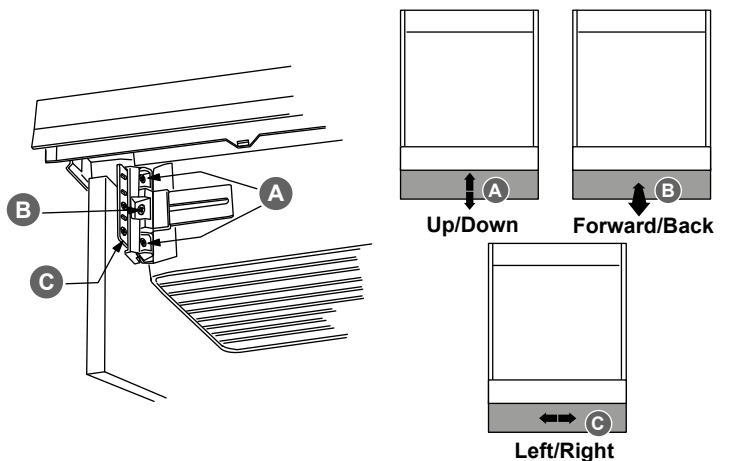

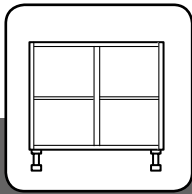

Section 1 - Kitchen installation - Base cabinets

BUOH - Leg conversion kit

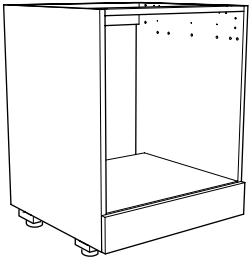

Runner fixing

Measure and mark runner fixing positions. Secure runner into place using the screws provided.

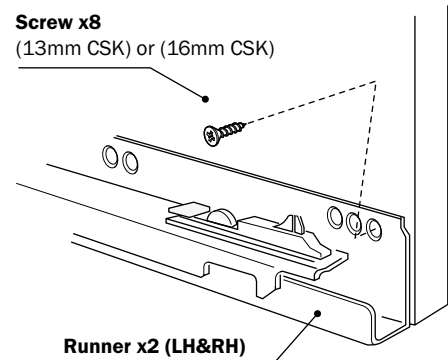
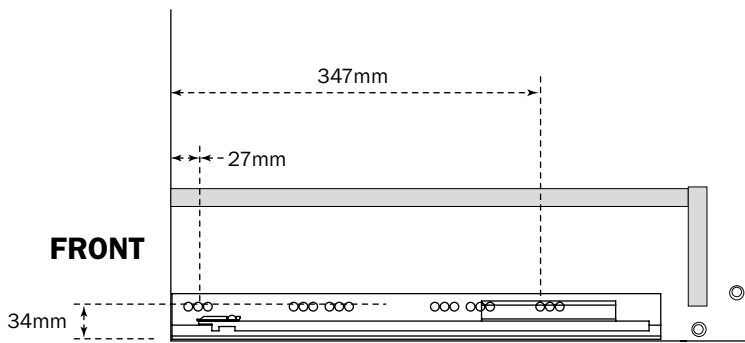

Leg rail assembly

- 1 Fit the rails to the underside of the cabinets using the dimensions below as a guide.

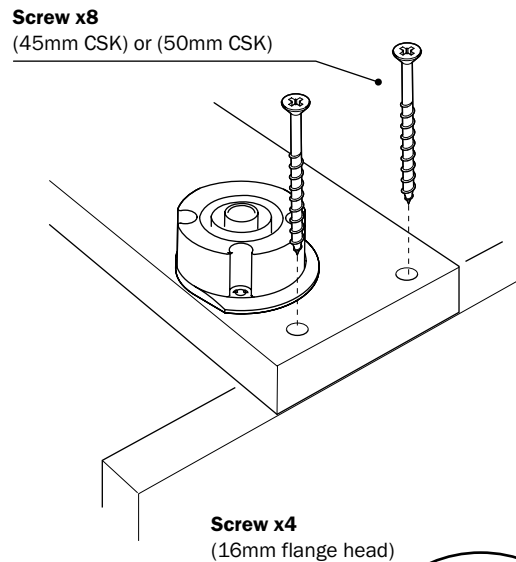
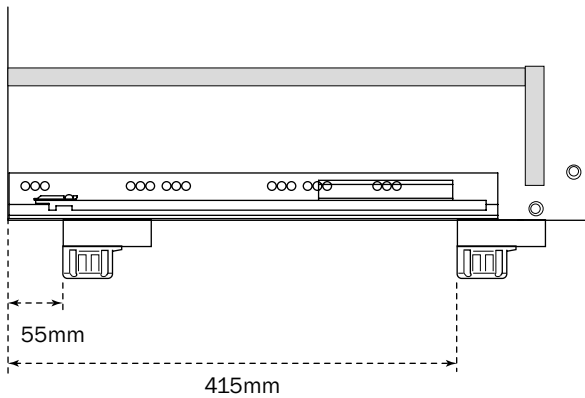

- 2 Assemble the drawer following the instructions, see **pages 31-42**.

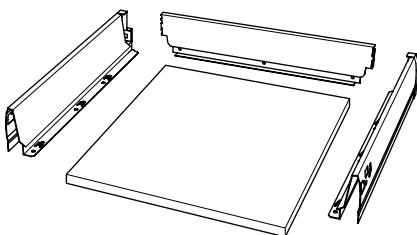

- 3 Mark and fit brackets to the back of drawer front. Secure the front to the drawer box then fit the drawer to the runners.

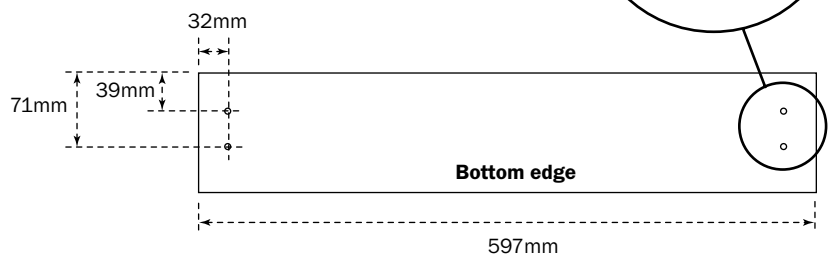

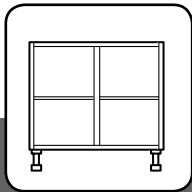

Section 1 - Kitchen installation - Base cabinets

Connecting and levelling

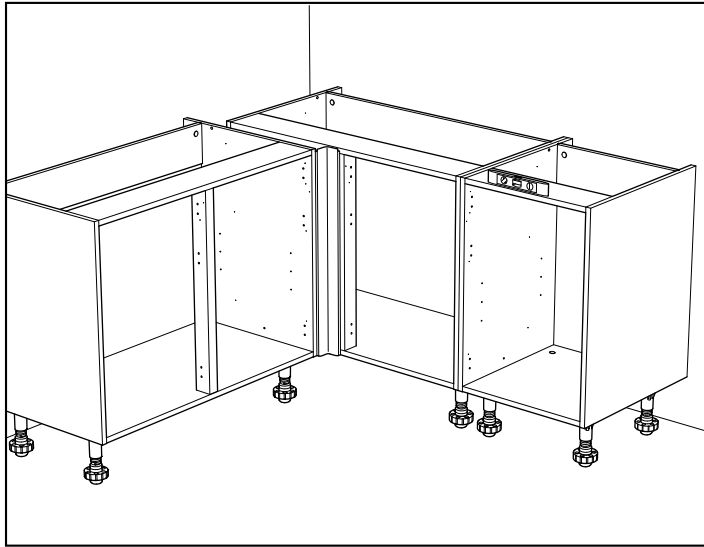

Place second cabinet up against the first. Adjust the cabinet to continue the level already set-up. Take care not to push cabinets closer to the corner than the mark on the wall. Do not connect to each other at this stage. Continue the run of cabinets on this wall until the first tower cabinet is reached or until the base cabinet run is complete.

Do not install open corner cabinets at this stage.

Having levelled a number of cabinets we recommend that the first few be connected together at this stage. Do not connect more than a run of 2.5m at a time.

Mark and drill 2 holes through the adjacent cabinet end panel only, away from hinges, drawer runners etc, using a 2.5mm drill bit. Then bradawl a starter hole and connect using the 30mm countersunk screws, to achieve a flush joint between cabinets. Take care not to force the cabinets out of line whilst drilling.

NOTE: For profile installation, see **Section 2**.

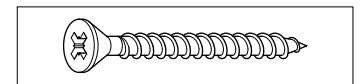
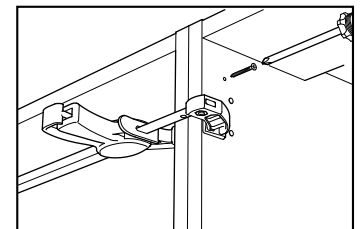
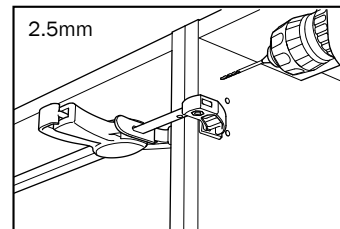
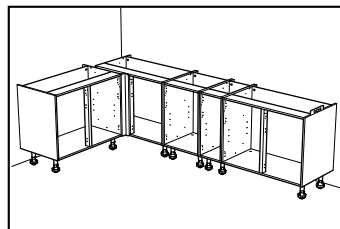
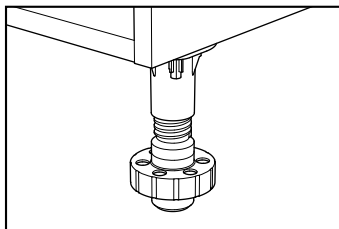

30mm CSK screw

Wall fixing

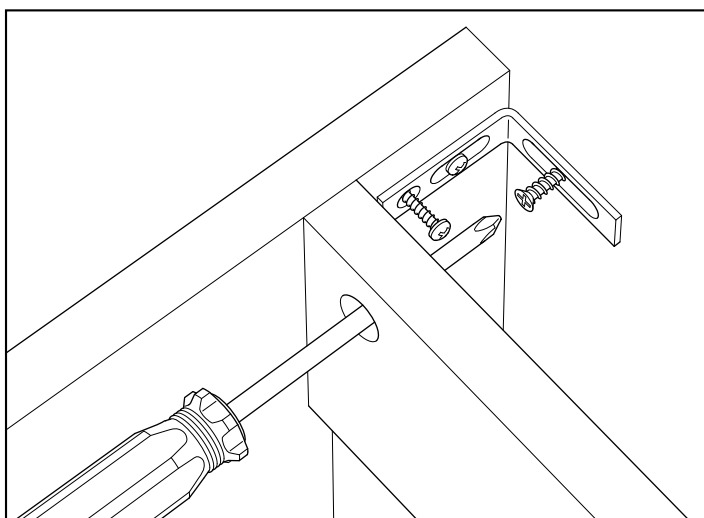

Base cabinets

Secure the cabinet to the wall fixing through the bracket using appropriate wall fixing screws. Once secure fit a cover cap over the holes in the rail.

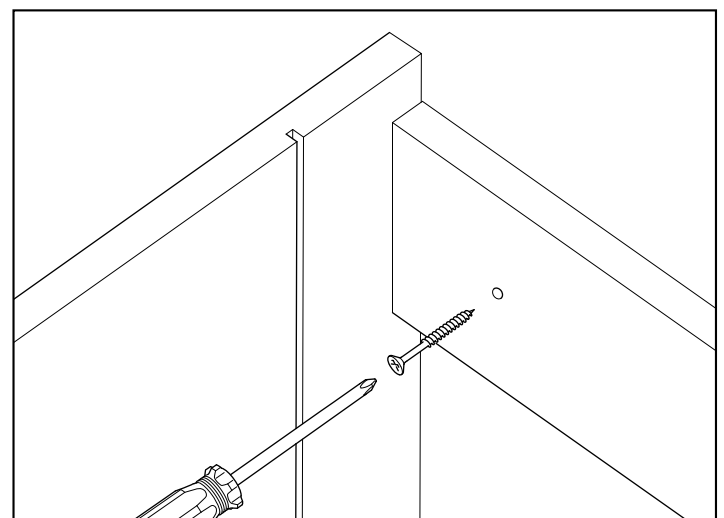

600 Built-under oven housing and floor mounted wall units

For built-under oven appliance cabinets, screw through the back rail.

NOTE: Wall fixings are not supplied.

Only use fixings suitable for the wall construction.

